



XUM VQM3 B3



XUM VQF6 B3

## HOT WATER SPRAY GUN ACCESSORIES

### FLEXIBLE HOSE

This hose has been selected to be used with all models of UMV hot water spray-gun as it's made in top quality EPDM to outwear oil, high temperatures, high pressures and assure a long service life. Inlet and outlet ends are provided with female quick couplings for easy assembly and safety.

- Max working temperature **LT** 160°C
- Max working pressure **LP** 8 bar
- Materials Hose **E0** EPDM  
Couplings **B3** AISI 316 Stainless steel

Code	Size (inch)	Hose length (m)
XUM VT25 E0	1/2"	25
XUM VT20 E0	3/4"	20

### QUICK COUPLINGS

XUM quick couplings are hot water spray gun accessories. It is convenient to assemble nozzle and spray gun. Please refer to below table for model no.

- Material **B3** AISI 316 Stainless steel

Code	Quick coupling tipo	Thread inch	Diameter mm
XUM VQF1 B3	Female	1/2" M	
XUM VQF2 B3	Female	1/2" F	
XUM VQF3 B3	Female	3/4" M	
XUM VQF4 B3	Female	3/4" F	
XUM VQF5 B3*	Female		13
XUM VQF6 B3*	Female		19
XUM VQM1 B3	Male	1/2" M	
XUM VQM2 B3	Male	1/2" F	
XUM VQM3 B3	Male	3/4" M	
XUM VQM4 B3	Male	3/4" F	

\* These couplings have a hose shank with the shown dia size.

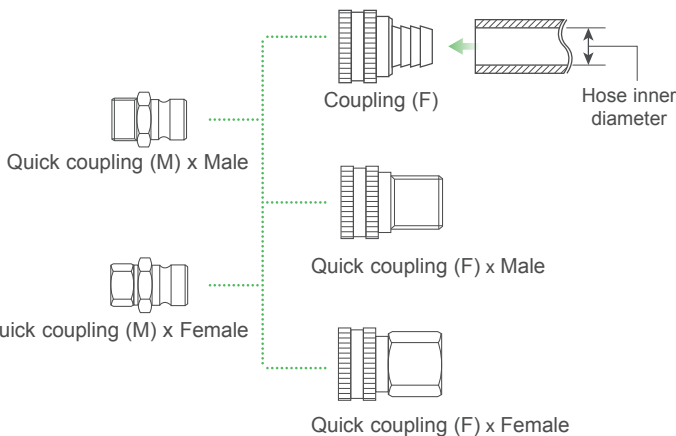

XUM US10 B2

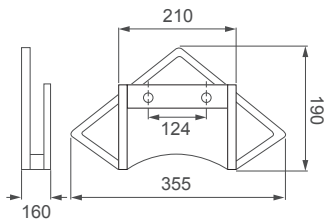

### HOSE STAND

XUM quick couplings are hot water spray gun accessories. It is convenient to assemble nozzle and spray gun. Please refer to below table for model no.

- Material **B2** AISI 304 Stainless steel

# UMS (PORTABLE WATER GUN)



with flat fan nozzle

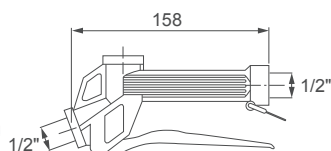

with lance



with UEA 0525 E31 air nozzle

## PORTABLE WATER SPRAY GUN

UMS portable water spray-guns are widely used in industry. They have a lock ring to fix the handle while operating for a comfortable long use. The gun has a 1/2" female thread for nozzles assembly. The most common applications of this spray-gun are:

- (1) Blowing off of water and surface dust with a UEA 0525 E31 air nozzles
- (2) Parts and environment cleaning with suitable flat fan nozzles
- (3) Liquid filling or packing with proper complementary accessories

- Typical applications Product cleaning  
Liquid addition  
Air spray gun
- Inlet / Outlet thread size 1/2" BSP
- Max working temperature **LT** 100°C
- Max working pressure **LP** 50 bar
- Max capacity **LQ** 70 l/min
- Weight **W** 0.17 / 0.25 kg
- Materials Inner parts **B1** AISI 303 Stainless steel  
Inside seal **E7** Viton  
Outside shell **E3** Acetalic resin